



JARD Trigger System for Weatherby Mark V

Operator's Instruction Manual



3149 Nest Ave. – Sheldon, IA 51201
Phone: 712-324-7409
Email: support@jardinc.com – www.jardinc.com

WARNING

This firearm is intended for use only by experienced competitive shooters and professionals. You must take responsibility for your own actions. We will not be responsible for any loss, injury, or death resulting from the use or misuse of this product.

The handling and use of firearm bears with a certain unavoidable risks, like sky diving and rock climbing. If you are not willing to accept responsibility for your own actions, guns are not for you.

The use of any custom parts or modifications may void any warranty from the manufacturer of your firearm. Returns will not be accepted on any parts that have been modified.

If you do not have a thorough understanding of this trigger and the purpose and function of all the parts, do not attempt to install this system. Have it installed by an experienced gunsmith.

Installation

1. With the rifle pointed in a safe direction, open the bolt and visually check the internal magazine and the chamber to verify the rifle is unloaded.
2. Remove the bolt from the action by depressing the trigger while sliding the bolt back. Then remove the screw ahead of the bottom metal and the screw behind the trigger guard to separate the action from the stock. **Note:** the internal magazine will be loose inside the stock once disassembled.
3. Remove the factory trigger by unscrewing the mounting bolt at the front of the trigger housing, just ahead of the trigger itself.
4. Install the JARD replacement Trigger System. Reuse the mounting screw to fix the JARD Trigger System to the action.
5. Reassemble the rifle and perform a function and safety checks before using the rifle.

YOUR JARD TRIGGER SYSTEM COMES SET FROM THE FACTORY, NO ADJUSTMENT NEEDED.

If you must make adjustments, follow these instructions carefully. Only adjust the trigger if you fully understand the adjustment process. Adjustments done incorrectly can make your firearm unsafe!

1. If either of the adjusting screws ever move easily with little to no resistance, they should be removed and thread locker should be reapplied to them before readjusting them according to the instructions below. Leaving screws loose will inevitably cause them to come out of adjustment and may cause the trigger to become unreliable and/or unsafe. Allow 24 hours for thread locker to cure before using the trigger.
2. To adjust the sear engagement, first cock the bolt and disengage the safety. With a 1/16" hex key, turn the sear engagement screw (8) clockwise slowly until the trigger "fires." From this specific point, turn the screw counter-clockwise 1/2 turn. The adjustment screw at this position provides the ideal amount of sear engagement to function safely /properly while minimizing pre-travel.
3. After the sear engagement has been properly set, the pull weight may be adjusted within the posted pull weight range. To adjust the pull weight, a 5/64" hex key may be used to adjust the trigger spring screw (6). Turn clockwise to increase the pull weight and counter-clockwise to decrease pull weight. (Note: pull weight can only be adjusted within the posted pull weight range safely. If you want to reach the other pull weight range, you can purchase a replacement spring from JARD (7). Do NOT trim your trigger return spring to reach lighter pull weights. Doing so will cause reliability and safety issues.)
4. Reassemble your rifle and perform all safety and function checks before using the rifle.

JARD Trigger System for Weatherby Mark V Parts Breakdown

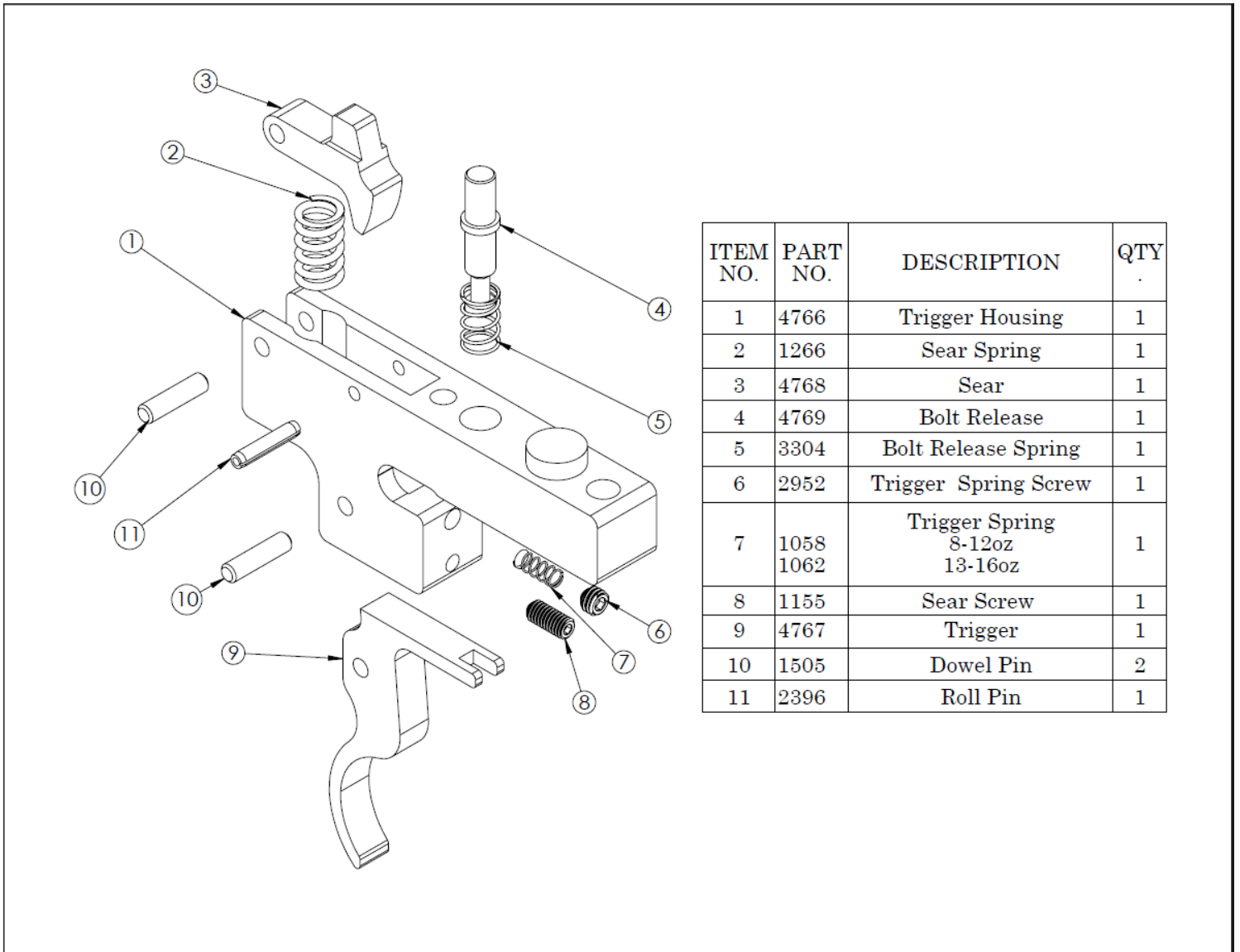

ITEM NO.	PART NO.	DESCRIPTION	QTY
1	4766	Trigger Housing	1
2	1266	Sear Spring	1
3	4768	Sear	1
4	4769	Bolt Release	1
5	3304	Bolt Release Spring	1
6	2952	Trigger Spring Screw	1
7	1058 1062	Trigger Spring 8-12oz 13-16oz	1
8	1155	Sear Screw	1
9	4767	Trigger	1
10	1505	Dowel Pin	2
11	2396	Roll Pin	1

JARD, Inc.

3149 Nest Ave. – Sheldon, IA 51201

Phone: 712-324-7409 – Email: support@jardinc.com

www.jardinc.com