



JARD Trigger Kit for Marlin® Centerfire Lever Rifles Installation Guide

Tools Needed:

- Flat head screwdriver
- Pen or other pointed object



3149 Nest Ave. – Sheldon, IA 51201
Phone: 712-324-7409
Email: support@jardinc – www.jardinc.com

Step 1:

With the rifle pointed in a safe direction, and **WITHOUT** putting your finger inside the trigger guard, ensure the rifle is empty of ammunition by actuating the lever back and forth until no ammunition is ejected. Visually inspect the chamber to ensure it is clear. Once you have confirmed that the chamber is clear, close the lever to bring the bolt forward.

Step 2:

With the rifle now properly cleared, open the lever to the half way open position as shown below. Remove the screw circled in the picture below with a flathead screwdriver.





Step 3:

With the screw removed in step 2, remove the lever, then remove the bolt by sliding it backward while keeping the hammer depressed.



Step 4:

Remove the ejector circled in the picture above. It should be loose and easily removed with fingers or pliers if necessary.



Step 5:

Next, remove the buttstock by removing the screw circled in the image to the left with the flathead screwdriver. The buttstock should slide off the rifle rearwards as shown below.

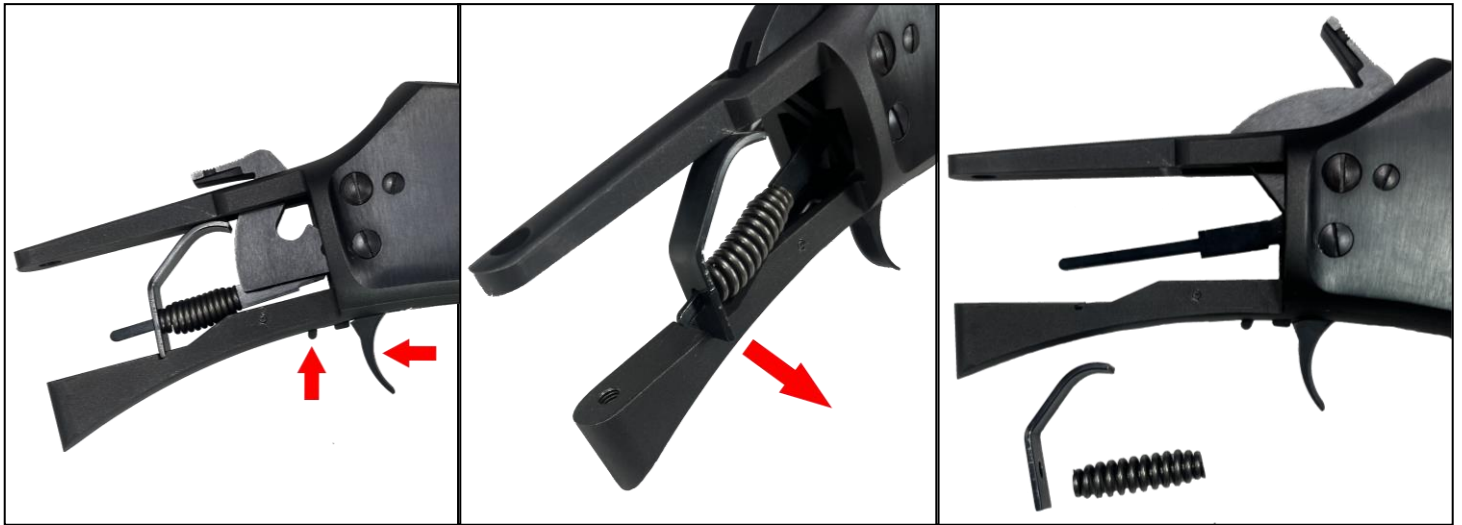

Step 6:

To remove the hammer spring, first release the hammer forward by depressing the button behind the trigger (this may require a pen or other pointed object) and simultaneously pulling the trigger as shown in the 1st image above. Then remove the hammer spring and spring retainer by sliding the spring retainer to the side as shown in the 2nd image above.



Step 7:

Remove screw circled and image above and remove the hammer and hammer strut by lifting it upward out of the receiver.



Step 8:

Flip the receiver over, left side up, and remove the two screws circled in the image.

Note: It is important to remember when reassembling that the shorter screw goes into the left side of the receiver while the longer screw goes into the bottom of the receiver as shown in the second image.

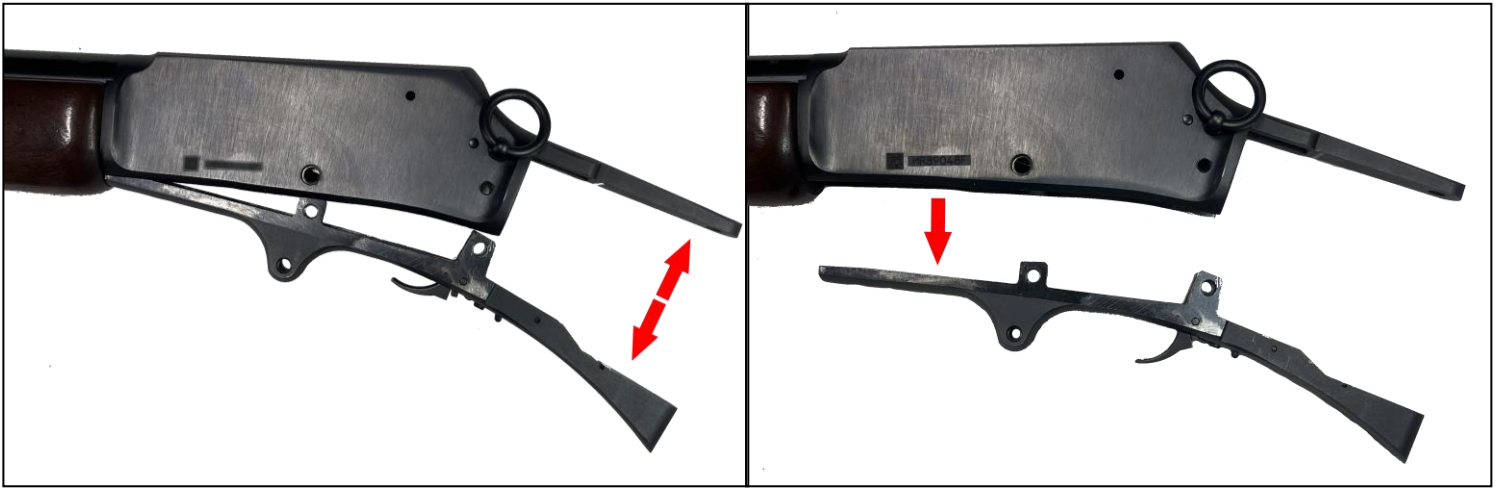

Step 9:

Separate the bottom plate from the receiver by first loosening them from each other on the tang/back end. Then rock the front end of the bottom plate out of the receiver.

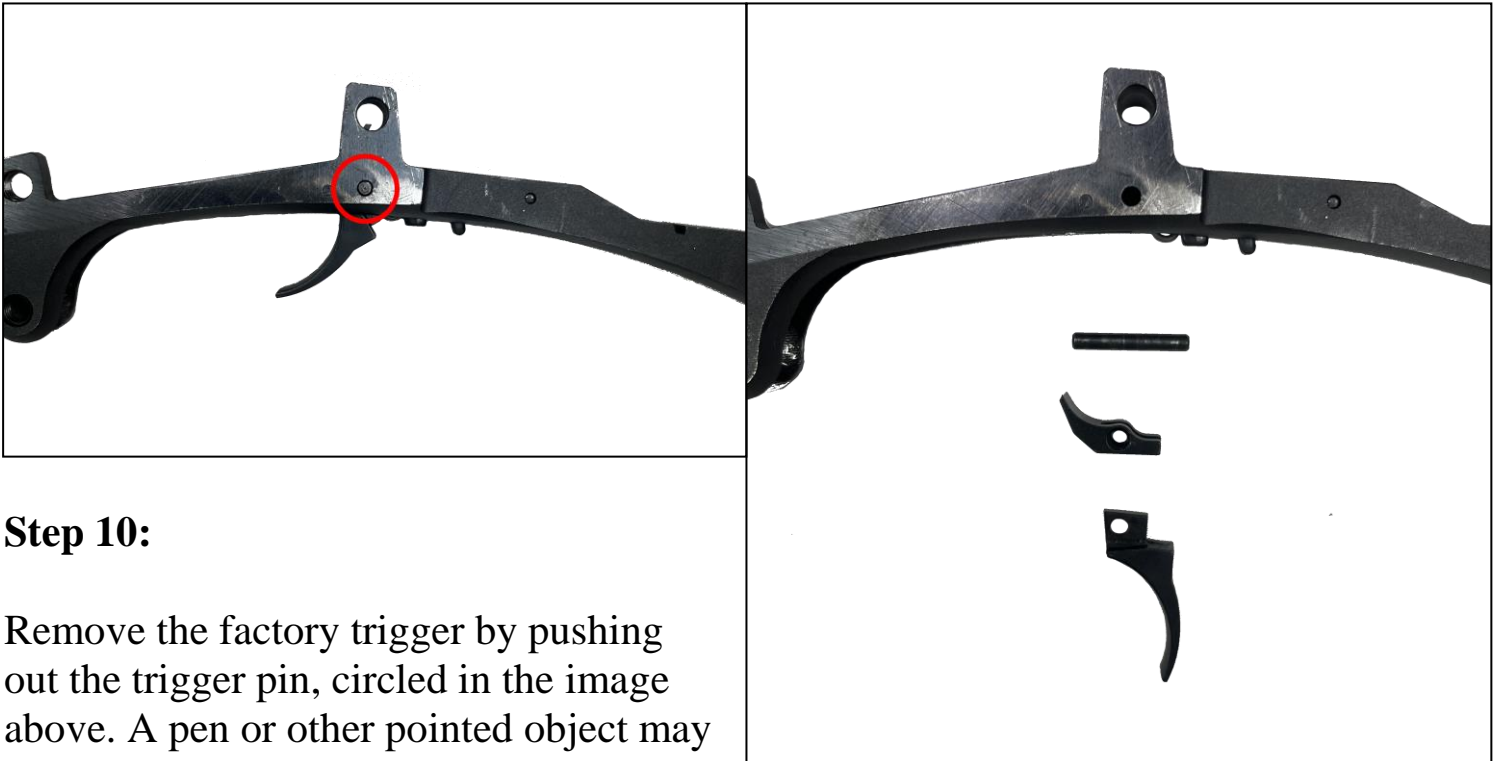

Step 10:

Remove the factory trigger by pushing out the trigger pin, circled in the image above. A pen or other pointed object may be required to get the pin started, but it otherwise should come out relatively easily.

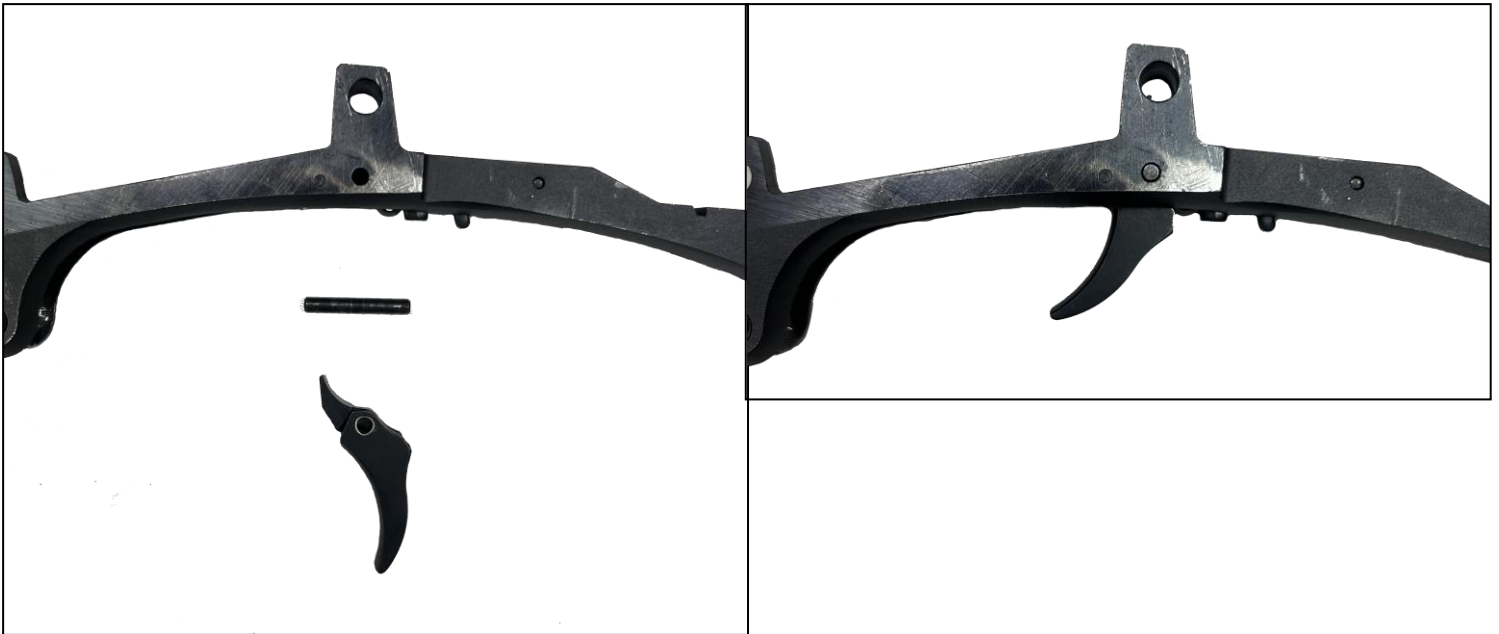

Step 11:

Replace the factory trigger with the JARD trigger using the same pin removed in Step 10.

Step 12:

Reassemble the rifle working backwards from Step 9.

Reassembly Notes:

- When reinstalling the hammer and hammer strut, you may need to depress the trigger slightly to get the hammer properly aligned with the screw and screw hole.
 - When reinstalling the lever, make sure both the bolt and the lever are in the same halfway position as shown in Step 2.
-

JARD, Inc.

3149 Nest Ave. – Sheldon, IA 51201

Phone: 712-324-7409 – Email: support@jardinc.com

www.jardinc.com